

marantz®



**AVAILABLE AT
DIGITAL CINEMA**

Model PM-KI RUBY Quick Start Guide

Integrated Amplifier

Welcome

Thank you for choosing a Marantz amplifier. This guide provides step-by-step instructions for setting up your amplifier.

Please do not return this unit to the store – call for assistance.



If you need help... :

If you need additional help in solving problems, contact Marantz customer service in your area. For details, see the Marantz homepage.

www.marantz.com

Before You Begin

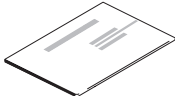
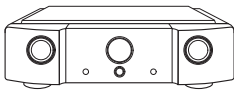
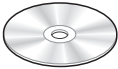
What's In the Box

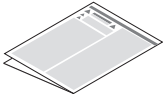
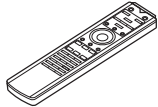
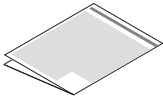
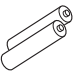
Quick Start Guide		Amplifier	
CD-ROM (Owner's Manual)		Power cord	
Safety Instructions		Remote control unit (RC005PMSA)	
Cautions on Using Batteries		R03/AAA batteries	

Required for Basic connections

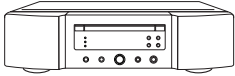
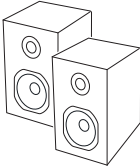
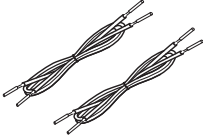
		
CD player	Speaker systems	Speaker cables



- These drawings are for illustrative purposes only and may not represent the actual product(s).

Setup

There are five steps to the setup process.

- 1** Install batteries in the remote control unit
- 2** Connect the speakers to the amplifier
- 3** Connect the CD player to the amplifier
- 4** Plug the power cord into a power outlet
- 5** Begin CD playback

1 Install batteries in the remote control unit

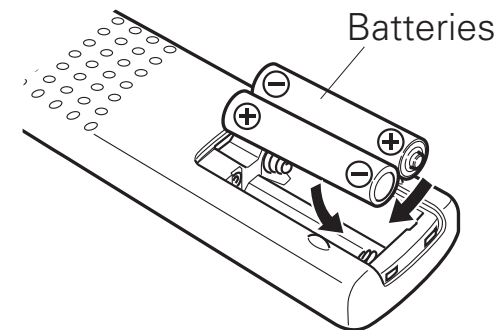
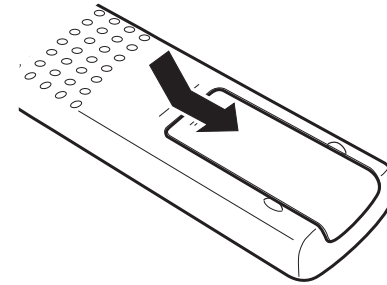

2 Connect the speakers to the amplifier

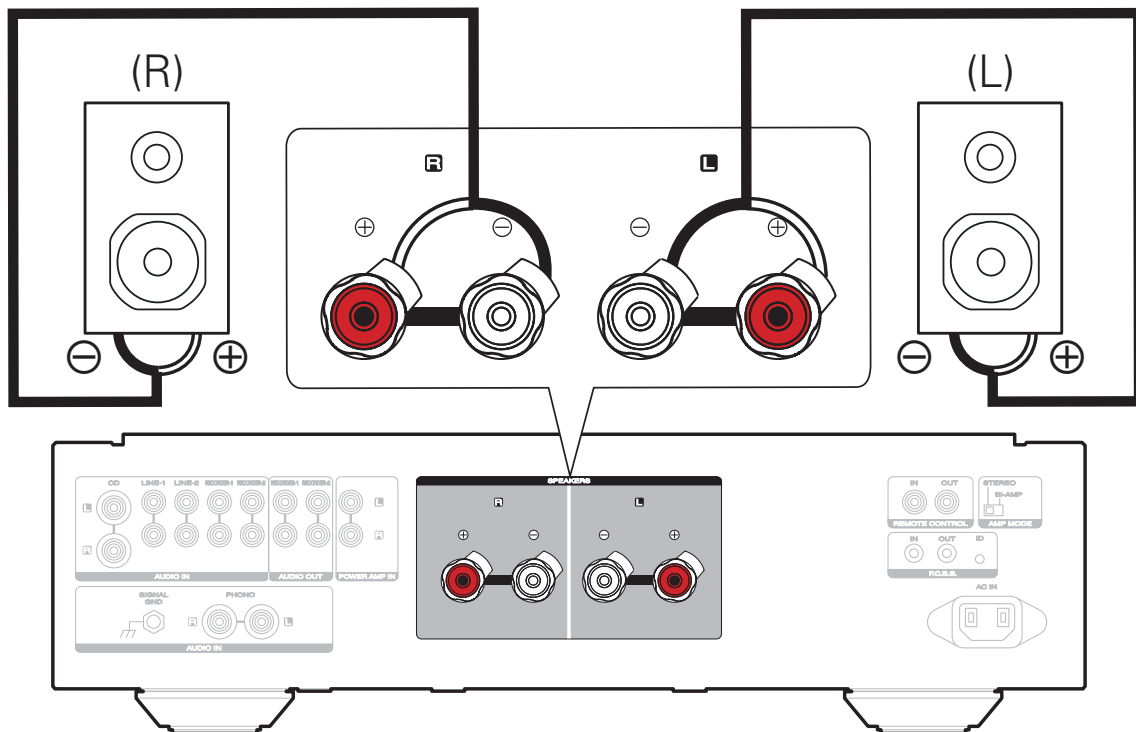

Connecting the speaker cables

- ① Peel off about 10 mm of sheathing from the tip of the speaker cable, then either twist the core wire tightly or apply solder to it.



- ② Turn the speaker terminal counterclockwise to loosen it.

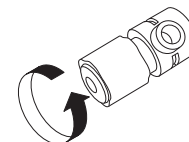

- ③ Insert the speaker cable's core wire to all the way into the speaker terminal.

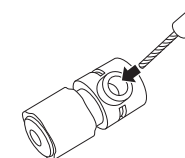

- ④ Turn the speaker terminal clockwise to tighten it.

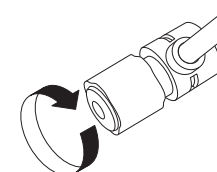

3 Connect the CD player to the amplifier

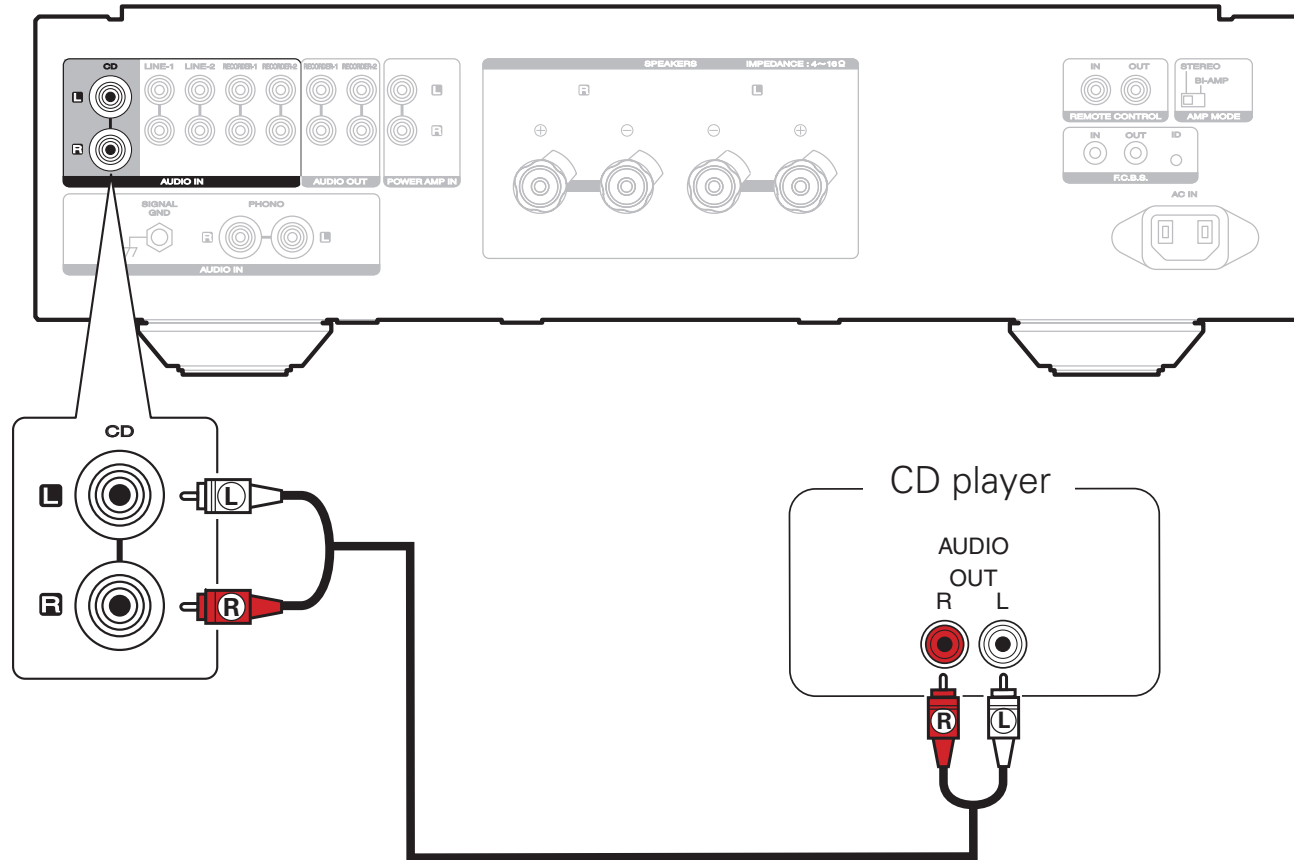

4 Plug the power cord into a power outlet

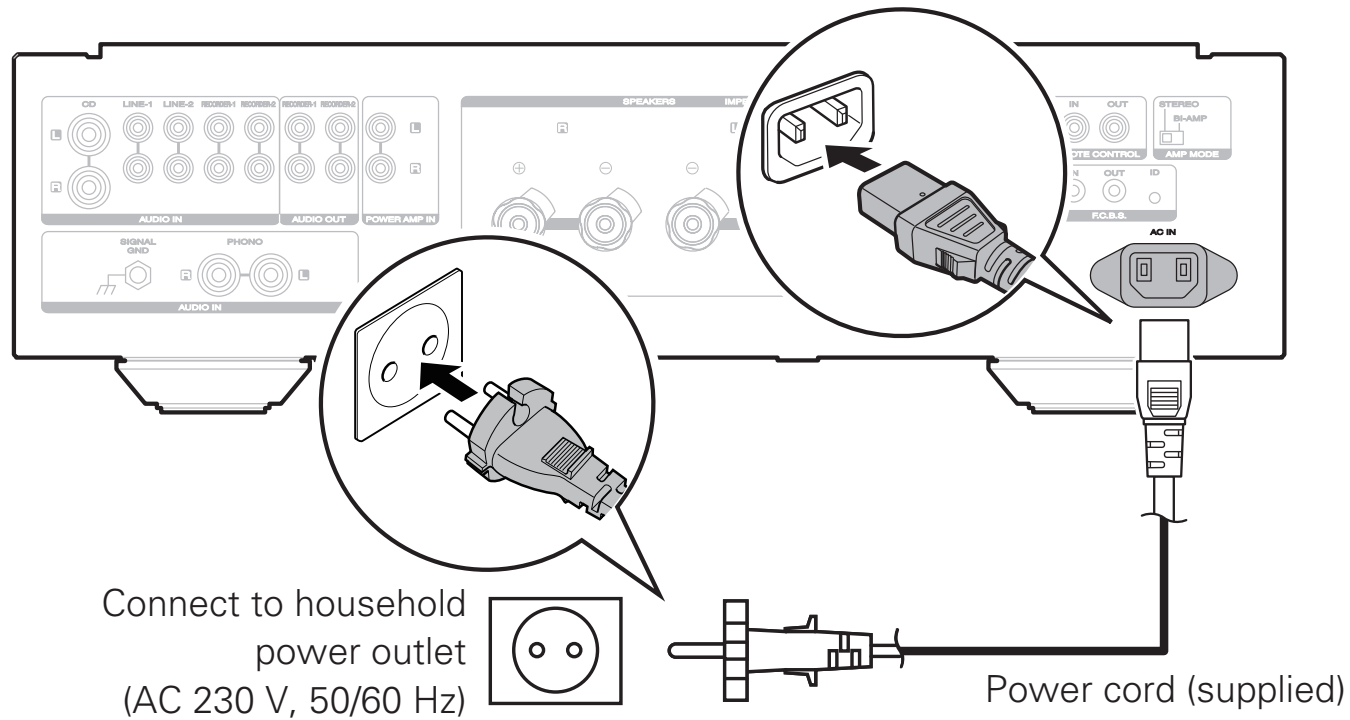

5 Begin CD playback

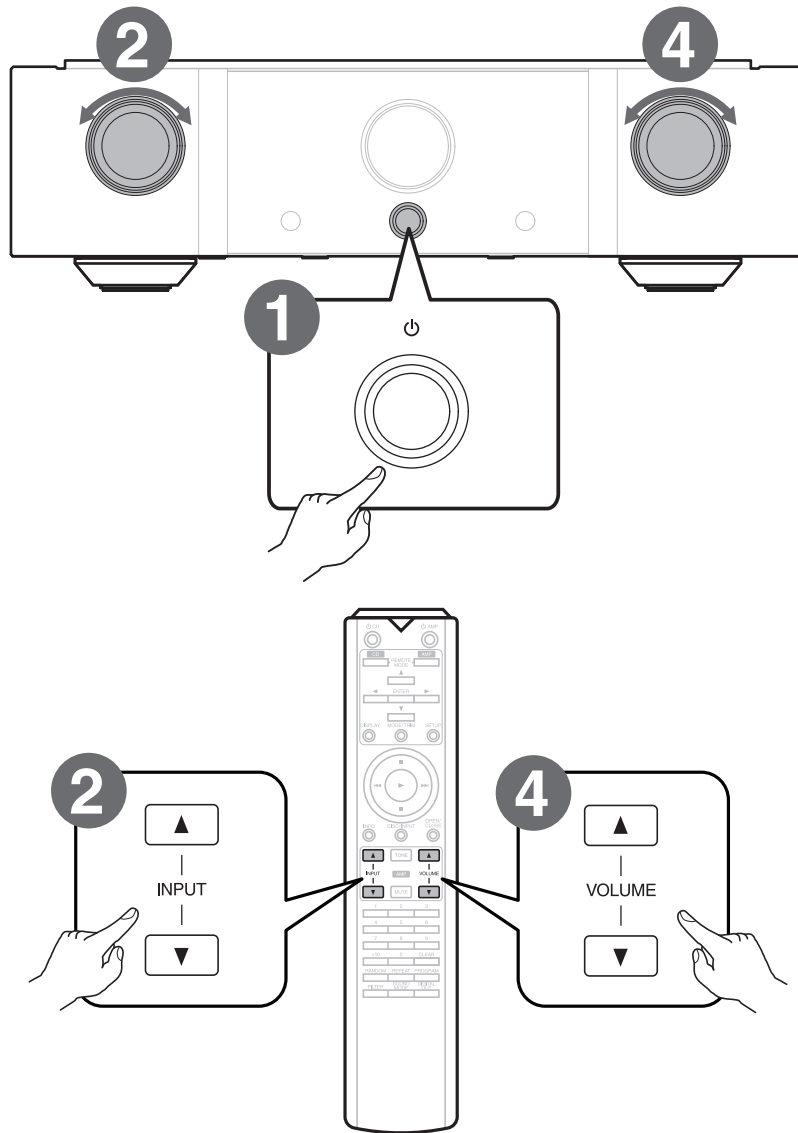

- 1 Press the power operation button.
- 2 Set the input source to “CD”.
“CD” is displayed on the display of this unit.
- 3 Play the CD player.

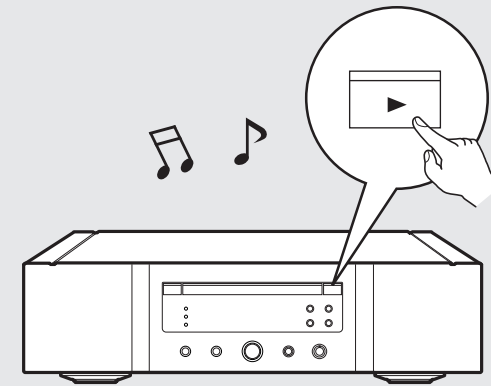

- 4 Adjust the volume.

Owner's Manual

Please reference to the Owner's Manual for more details about the setup and operation of the amplifier and its features.

❏ Online Version

Enter the following URL into your web browser:
manuals.marantz.com/PMKIRUBY/EU/EN/

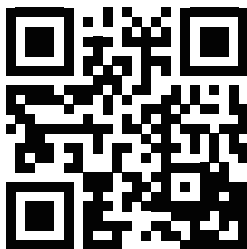

Online Manual

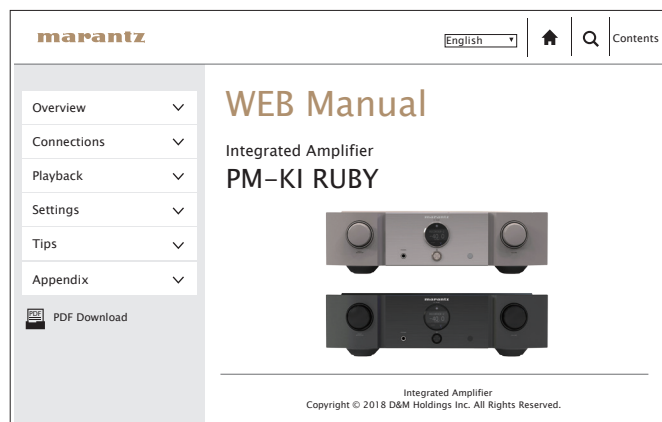

❏ Printable Version

Access the print version of the owner's manual from the included CD-ROM or select the "PDF Download" link from the Online Version.

1

Insert the disc into your PC.

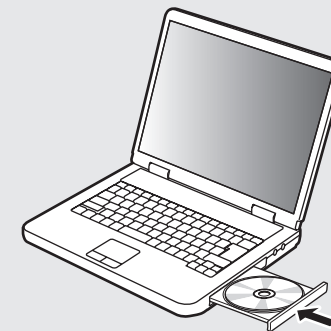

2

Follow the screen or double click on the PDF file.

www.marantz.com

You can find your nearest authorized distributor or dealer on our website.

marantz[®] is a registered trademark.