

Ci130QS



Architectural Speaker

OBSESSED WITH HIGH RESOLUTION

Product Overview

The KEF Ci130QS is a premium high performance speaker designed for in-ceiling and flush mount installations where a square shaped assembly is preferred. It's a coincident point source design featuring KEF's proprietary "sit-anywhere" Uni-Q® technology with a driver array that includes a 19mm high frequency aluminium dome tweeter mounted in the acoustic centre of the 130mm low frequency woofer. The tweeter features KEF's Tangerine Waveguide engineered to enhance high frequency dispersion and when combined with the Uni-Q array, creates a speaker that delivers exceptionally smooth and consistent coverage across a wide listening area. The KEF Ci130QS is constructed using weather resistant components and the Ultra-Thin Bezel and grille are treated with a UV protective finish making this speaker ideal for hi-fidelity applications in premium commercial venues such as luxury hotels, conference centres, and restaurants.

Key Features

KEF "sit-anywhere" Uni-Q® Technology – This proprietary driver array places the tweeter in the acoustic centre of the woofer delivering wide dispersion with consistent sound characteristics throughout the space. Because the high and low frequencies originate from the same point, acoustic lobing problems common to other speaker designs are virtually eliminated allowing fewer speakers to deliver smooth coverage across a wide listening area.

Tangerine Waveguide – In addition to protecting the driver, the Tangerine Waveguide further enhances dispersion allowing for 130 degrees of coverage

Weather Resistant – Manufactured using a proprietary plating and powder coating process, the KEF Ci130QS is UV protected and designed to withstand the harshest operating environments.

Ultra-Thin Bezel (UTB) – To maintain a premium aesthetic appearance, the ABS bezel was carefully engineered to be as thin as possible while maintaining the necessary structural rigidity.

Magnetic Grille – For security and ease of installation the grille attaches by a powerful magnetic circuit and can be painted to match any décor.

IP64 Certification – The speaker passed official IEC testing to ensure that splashing water would have no harmful effects on assembly components.



Architect and Engineer Specifications

The speaker shall be designed for in-ceiling flush mount installations and utilise a coincident point source design with the high frequency tweeter mounted in the acoustic centre of the low frequency woofer. The driver array shall be mounted in a square shaped assembly.

The speaker shall consist of a 130mm low frequency woofer and a vented 19mm aluminium dome high frequency tweeter featuring a waveguide for improved dispersion mounted in a UV protected ABS baffle with a paintable bezel of no more than 5mm in width. The grille shall also be paintable, include a paint shield, and attach by a powerful magnetic circuit for ease of installation and security. The speaker design shall be open back and deliver a minimum frequency response of 45Hz - 34kHz +/- 6 dB. The speaker shall not weigh more than 1.4kg and be available with a rough in frame kit.

The nominal impedance of the speaker shall be 8 ohms and it must achieve a minimum pressure sensitivity of 87 dB SPL at 1 meter on-axis with an input of 2.83 volts. The crossover frequency between the woofer and tweeter shall be 3.8kHz. The speaker shall meet numerous safety and performance standards listed by regulatory bodies around the world.

The speaker shall be the KEF Ci130QS.

Specifications

Model	Ci130QS	
Series	Q Series	
Nominal impedance	8Ω	
Sensitivity (2.83V/1m)	87dB	
Frequency response (±6dB) open-backed	45Hz - 34kHz	
Nominal coverage	130°	
Max SPL	103dB	
Crossover frequency	3.8kHz	
Drive units	LF	130mm (5.25in.) Uni-Q
	MF	-
	HF	19mm (0.75in.)
Recommended amplifier power	10 - 100 W	
Recommended high-pass filter	50Hz	
Product external dimensions (H x W x D)	184 x 184 x 83 mm (7.24 x 7.24 x 3.27in.)	
Cut-out dimensions (H x W)	154 x 154mm (6.10 x 6.10in.)	
Mounting depth from surface	77.1mm (3.03in.)	
Net Weight	1.4kg (3.1lbs.)	
Optional rough in frame	RIF130S	
Optional rear enclosure	RNC130S	
Ideal rear volume	15L	
Minimum rear volume	10L	

Visit KEF.COM for more about KEF and its products.

KEF reserves the right, in line with continuing research and development, to amend or change specifications. E&OE.

The Ci speakers that utilise THX in the model name have undergone and passed certified THX approval.

Directivity Index

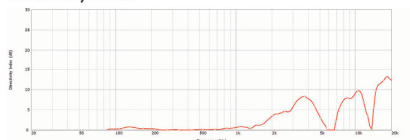

Beamwidth -3dB

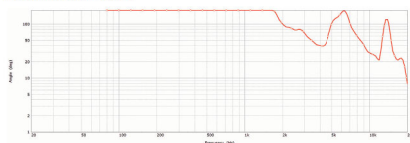

Beamwidth -6dB

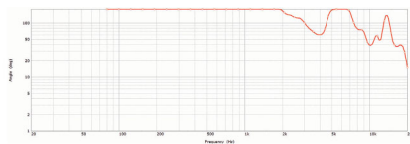

Impedance

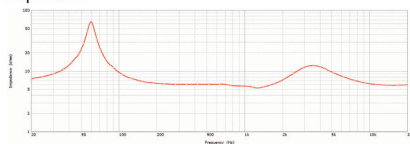

Sensitivity (2.83V/1m)

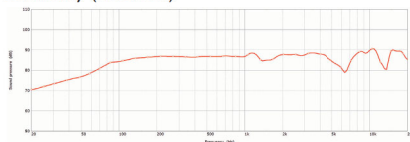

Polar Responses

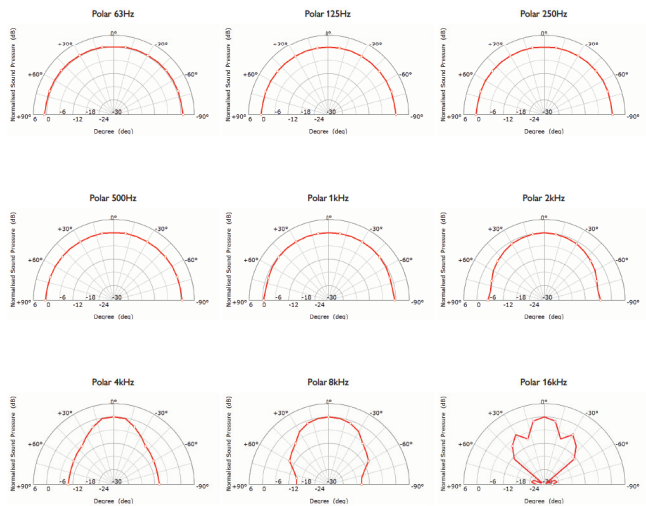

Mechanical Diagrams

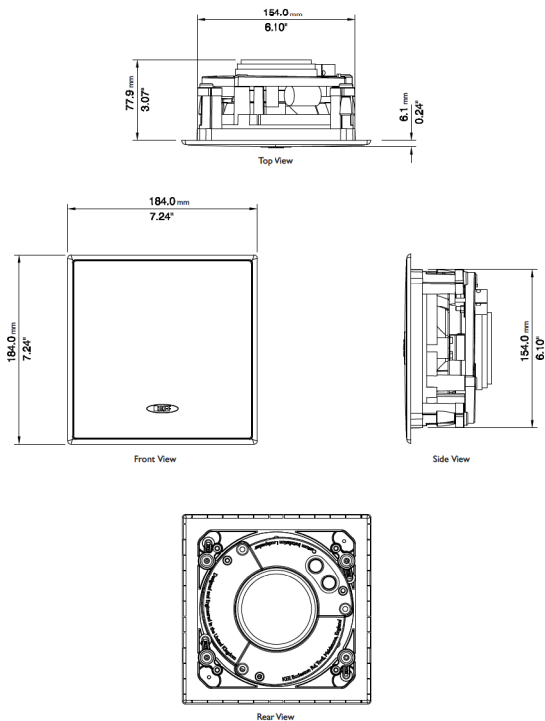

Dimensions in mm (inches)

KEF reserves the right, in line with continuing research and development, to amend or change specifications. E&OE.